

**PLEASE  
PLEASE  
PLEASE**

MELT COLLECTION





## MELT COLLECTION

Melt bathroom is a collection of Melbourne made bathroom items sand cast in bronze and aluminium, designed to enhance a bathroom's purpose beyond the execution of their simplistic function.

Their name is taken from the process of melting the metal before pouring it into a sand casting mould. Each piece is lightly buffed smooth, but not polished, allowing the gritty sand marks, imperfections and variations obtained during the casting process to be seen and celebrated — giving each item its uniqueness.

These are heated and given a penetrating wax treatment but will eventually darken with patina over time. If preferred they can be brightened by polishing with a cloth and appropriate metal cleaner.





## MELT BUTTONS

Melt Buttons are strong, multi-use objects. Use them as towel hooks, coat hooks, bag hooks, or door/drawer pulls. Each piece is lightly buffed smooth, but not polished, allowing the gritty sand marks, imperfections and variations obtained during the casting process to be seen and celebrated— giving each item its unquity.

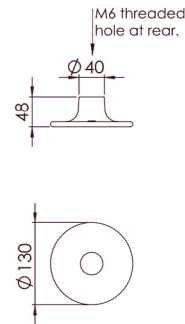

### MELT LARGE BUTTON

#### MATERIALS

Cast Aluminium or Bronze

#### FINISH

Buffed and waxed

#### SUPPLIED

Fixings for plaster/masonry/timber

#### LEAD TIME

Ten to twelve weeks

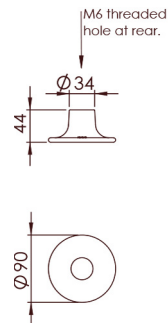

### MELT SMALL BUTTON

#### MATERIALS

Cast Aluminium or Bronze

#### FINISH

Buffed and waxed

#### SUPPLIED

Fixings for plaster/masonry/timber

#### LEAD TIME

Ten to twelve weeks

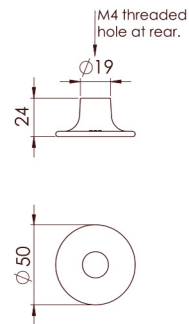
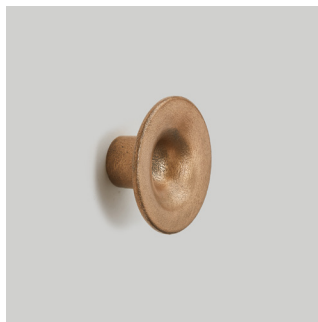

### MELT MINI BUTTON

#### MATERIALS

Cast Aluminium or Bronze

#### FINISH

Buffed and waxed

#### SUPPLIED

Fixings for plaster/masonry/timber

#### LEAD TIME

Ten to twelve weeks



## MELT ROLL HOLDER

These were the first of the Melt bathroom collection to be designed. The curved shape and organic nature of the cast material gives these utilitarian objects a soft sculptural appearance. Each piece is lightly buffed smooth, but not polished, allowing the gritty sand marks, imperfections and variations obtained during the casting process to be seen and celebrated— giving each item its uniqueness.

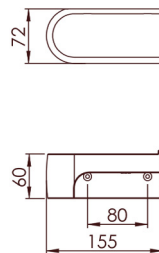

### MELT ROLL HOLDER

#### MATERIALS

Cast Aluminium or Bronze

#### FINISH

Buffed and waxed

#### SUPPLIED

Fixings for plaster/masonry/timber

#### LEAD TIME

Ten to twelve weeks





## MELT TOWEL RAILS

Intended not to just hold a towel but display it. The Melt Towel Rails are sister to the Melt Toilet Roll Holders. Each piece is lightly buffed smooth, but not polished, allowing the gritty sand marks, imperfections and variations obtained during the casting process to be seen and celebrated — giving each item its uniqueness.

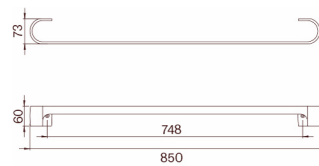

### MELT TOWEL RAIL 850MM

#### MATERIALS

Cast Aluminium or Bronze

#### FINISH

Buffed and waxed

#### SUPPLIED

Fixings for plaster/masonry/timber

#### LEAD TIME

Ten to twelve weeks

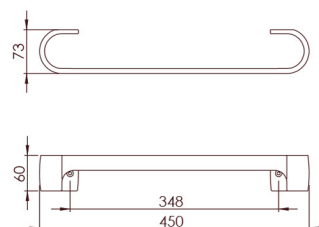

### MELT TOWEL RAIL 450MM

#### MATERIALS

Cast Aluminium or Bronze

#### FINISH

Buffed and waxed

#### SUPPLIED

Fixings for plaster/masonry/timber

#### LEAD TIME

Ten to twelve weeks



## MELT BASIN

Raw, refined, beautiful, luxurious, indulgent, solid and forever. The V shaped fluting around the basins was inspired by a series of bridges located in the eastern suburbs of Melbourne. Each piece is lightly buffed smooth, but not polished, allowing the gritty sand marks, imperfections and variations obtained during the casting process to be seen and celebrated— giving each item its uniqueness.

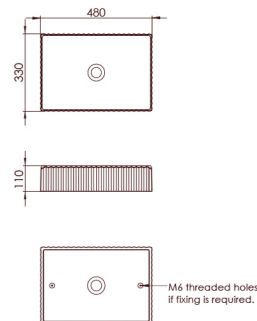

### MELT BASIN

#### MATERIALS

Cast Aluminium or Bronze

#### FINISH

Buffed and waxed

#### SUPPLIED

2x M6 threaded rods, nuts & washers

#### LEAD TIME

Ten to twelve weeks



Please Please Please is a Melbourne-based industrial design studio specialising in the design and manufacture of bespoke lighting, furniture and architectural elements. Established in 2011, a broad portfolio of bespoke commissions, predominantly for the Hospitality Industry, has been developed. The ever changing, creative nature of this industry to produce imaginative, appropriate pieces has allowed Please Please Please to naturally evolve into creating crafted object collections for the retail market.

Consistently underscored by a belief in the functional and enduring quality of each piece, Please Please Please design and manufacture products that thoughtfully engage with the space they are intended for. Working with a locally based foundry, team of fabricators, timber-workers, and artisans has developed a close, cooperative spirit to produce characterful, quality driven and desirable objects.

**STOCKISTS**

Go to website Store and click  
on desired product.

[pleasepleaseplease.com.au](http://pleasepleaseplease.com.au)

**ARCHITECTURAL  
& TRADE ENQUIRIES**

[dan@pleasepleaseplease.com.au](mailto:dan@pleasepleaseplease.com.au)

0488 116 949

**ALL OTHER ENQUIRIES**

[info@pleasepleaseplease.com.au](mailto:info@pleasepleaseplease.com.au)

0417 436 487



PPP PREFERS

WELL DESIGNED	TO	JUST DESIGNED.
UNEMBELLISHED	TO	EXAGGERATED.
DELICATE	TO	FLIMSY.
FACT	TO	FALSEHOOD.
SPIRITED	TO	SPINELESS.
CONNECTED	TO	CUT-OFF.
RADICAL	TO	IRRATIONAL.
OPINION	TO	OPINIONATED.
FERVENT	TO	APATHETIC.
OPEN-MINDED	TO	SLACK JAWED.
THOUGHTFUL	TO	THOUGHTLESS.

---

PLEASEPLEASEPLEASE.COM.AU

© PLEASE PLEASE PLEASE 2021